



PrepPaU® CookRite® Mixrite®



SALAMANDER / CHEESEMELTER BROILER INSTALLATION OVERVIEW

ATSB-36 / ATCM-36

 Toll Free: (855) 855-0399

 info@atosausa.com

 www.atosausa.com

Important Notes:

- Ensure the installation surface is flat, solid, level, and capable of supporting the weight of the Salamander Broiler.
- For wall mounting: The wall must be perpendicular to the ground and strong enough for secure anchoring and capable of supporting the broiler's weight.
- For range mounting: The range must be positioned on level ground and properly stabilized.
- Use appropriate safety gear and lifting support when positioning the broiler.
- Follow all manufacturer safety warnings and local building or fire codes. Ensure the wall is flat, solid, level, and perpendicular to the ground.

Required Tools & Materials:

Wall Mount:

Impact drill with 8mm drill bit

Wall anchors and screws (as provided or specified)

Level and measuring tape

Range Mount:

Screwdriver or wrench

Tapping screws

Lifting jack (for safe placement of the broiler)

Connecting rod (Part No. 21108001042)

Wall-Mount Installation Steps:

Step 1: Drill Mounting Holes

Using an impact drill, create two holes in the wall to accommodate the screws.

Hole diameter: 8mm (based on the actual screw size)

Hole depth: 50mm–55mm

The distance between the two holes should match the dimensions of the hanging board (refer to the diagram for accurate spacing).

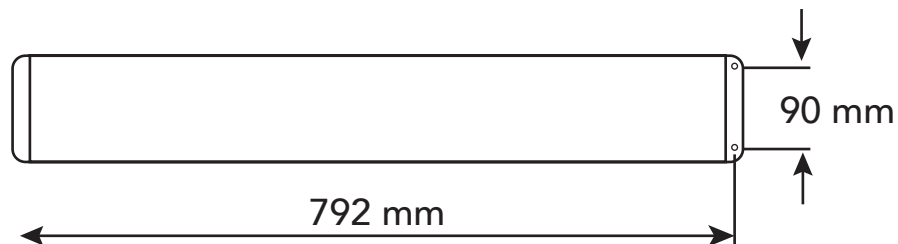

Step 2: Attach the Hanging Board Base

Secure the hanging board base to the wall using the appropriate screws provided.

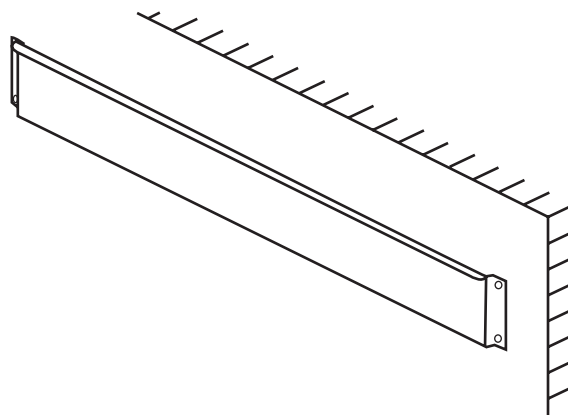

Step 3: Remove Screws from the Broiler

On the back of the Salamander Broiler, locate and remove the five screws indicated within the dotted frame in the diagram.

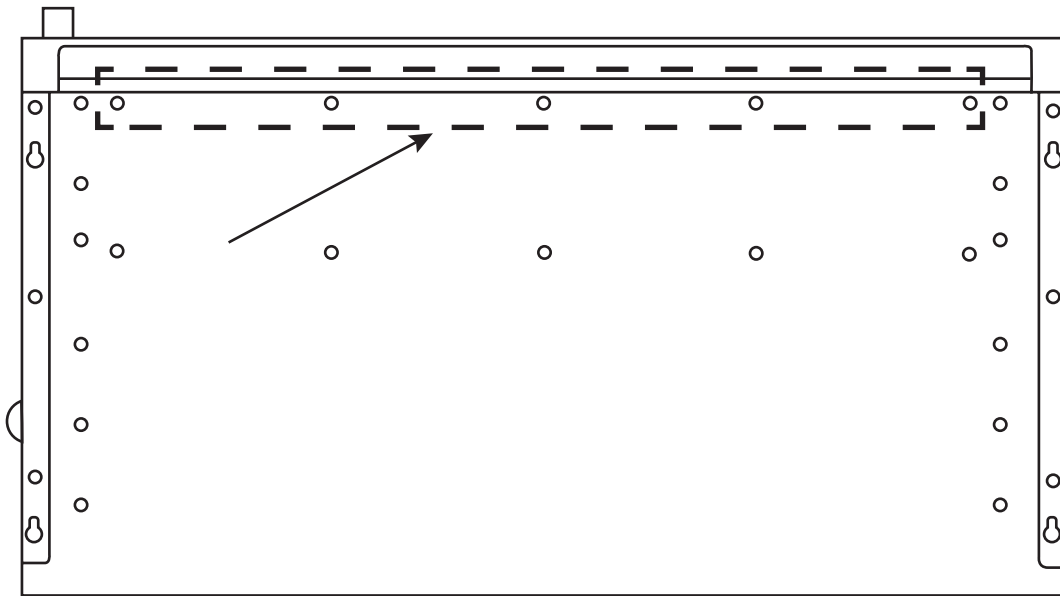

Step 4: Attach Hanging Board to the Broiler

Using the five screws removed in **Step 3**, affix the hanging board securely to the back of the Salamander Broiler.

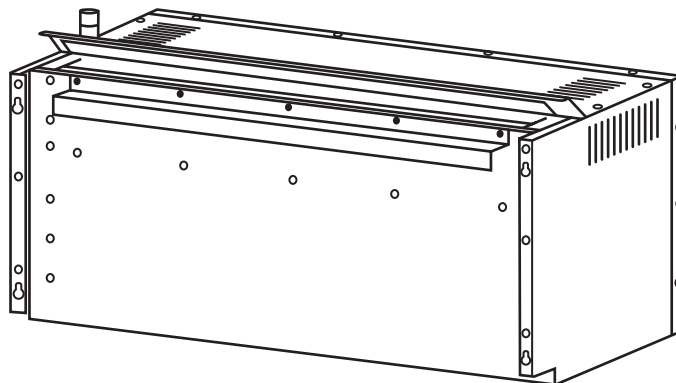

Step 5: Mount the Broiler on the Wall

Carefully hang the Salamander Broiler onto the wall-mounted hanging board base. Ensure it is properly seated and securely in place.

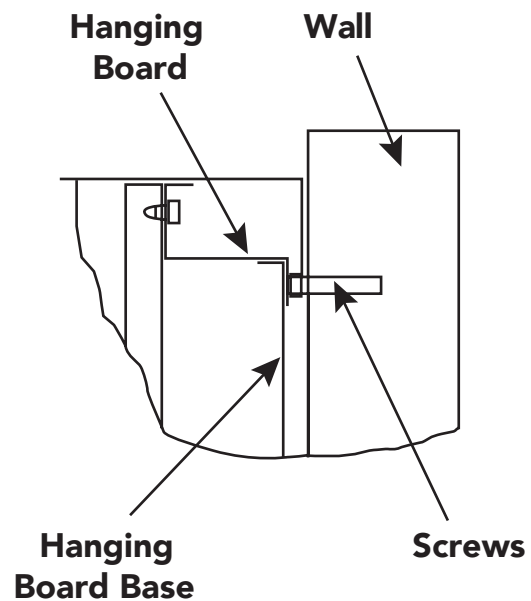
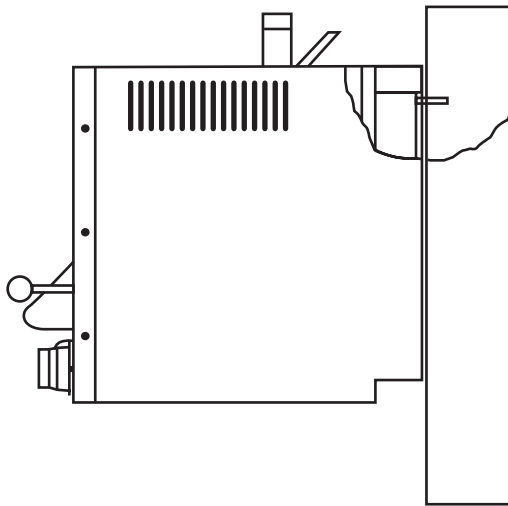
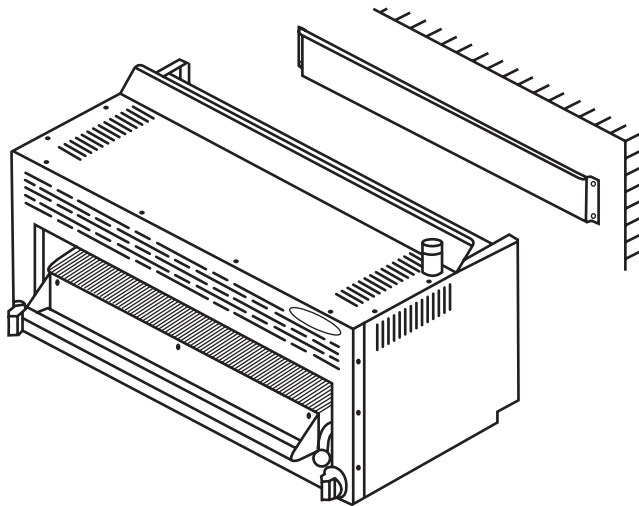

Additional Notes:

The wall must be even, firm, and capable of bearing the weight of the broiler.
Use caution during the hanging process to prevent injury or equipment damage.

Range Mount Installation Steps:

Step 1: Prepare the Range

Remove the rear panel and inserted bar from the 36" Gas Restaurant Range.

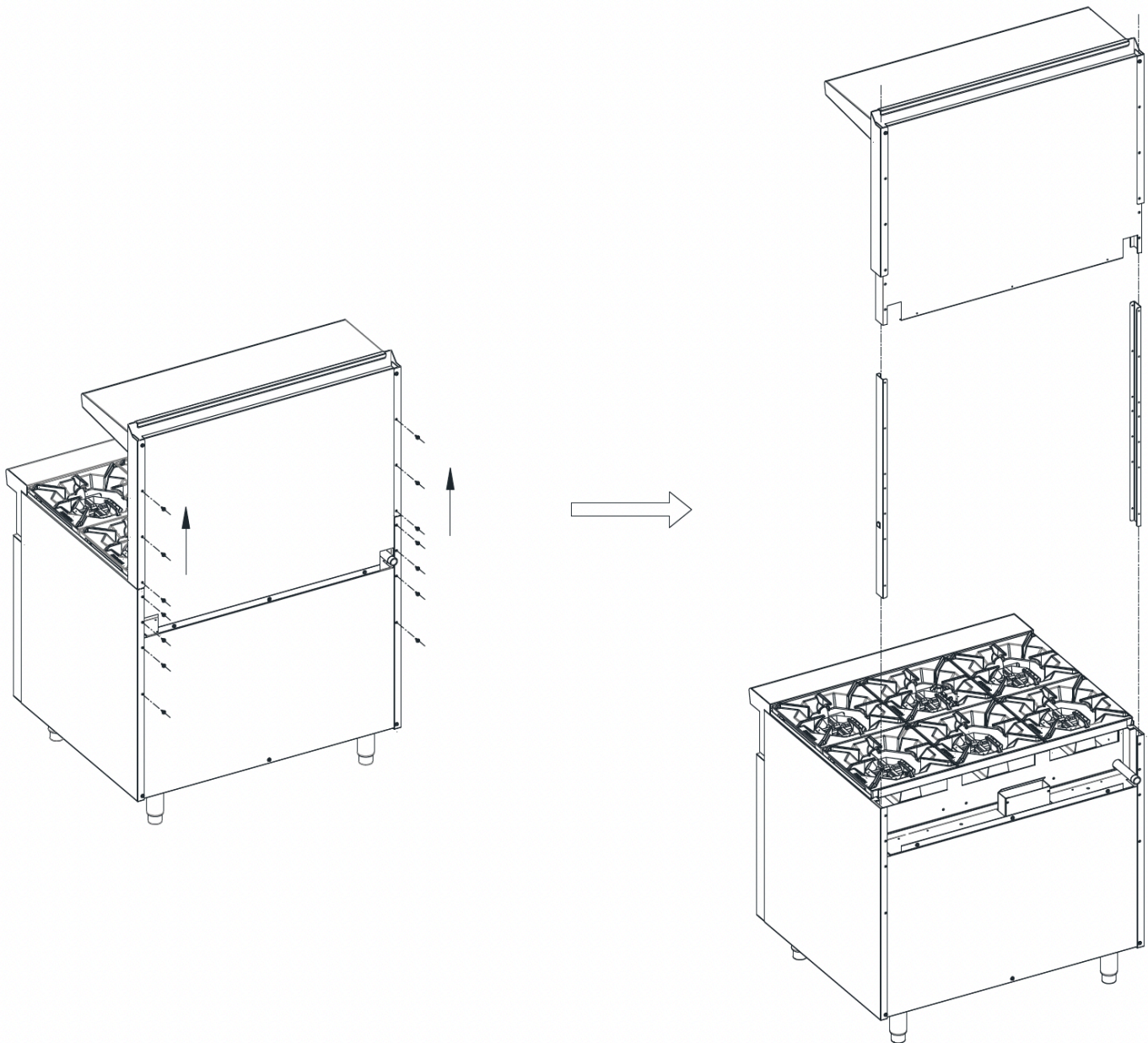

Step 2: Install the Connecting Rod

Insert the connecting rod (Part No. 21108001042) into the designated position on the rear panel.
Secure it in place using tapping screws.

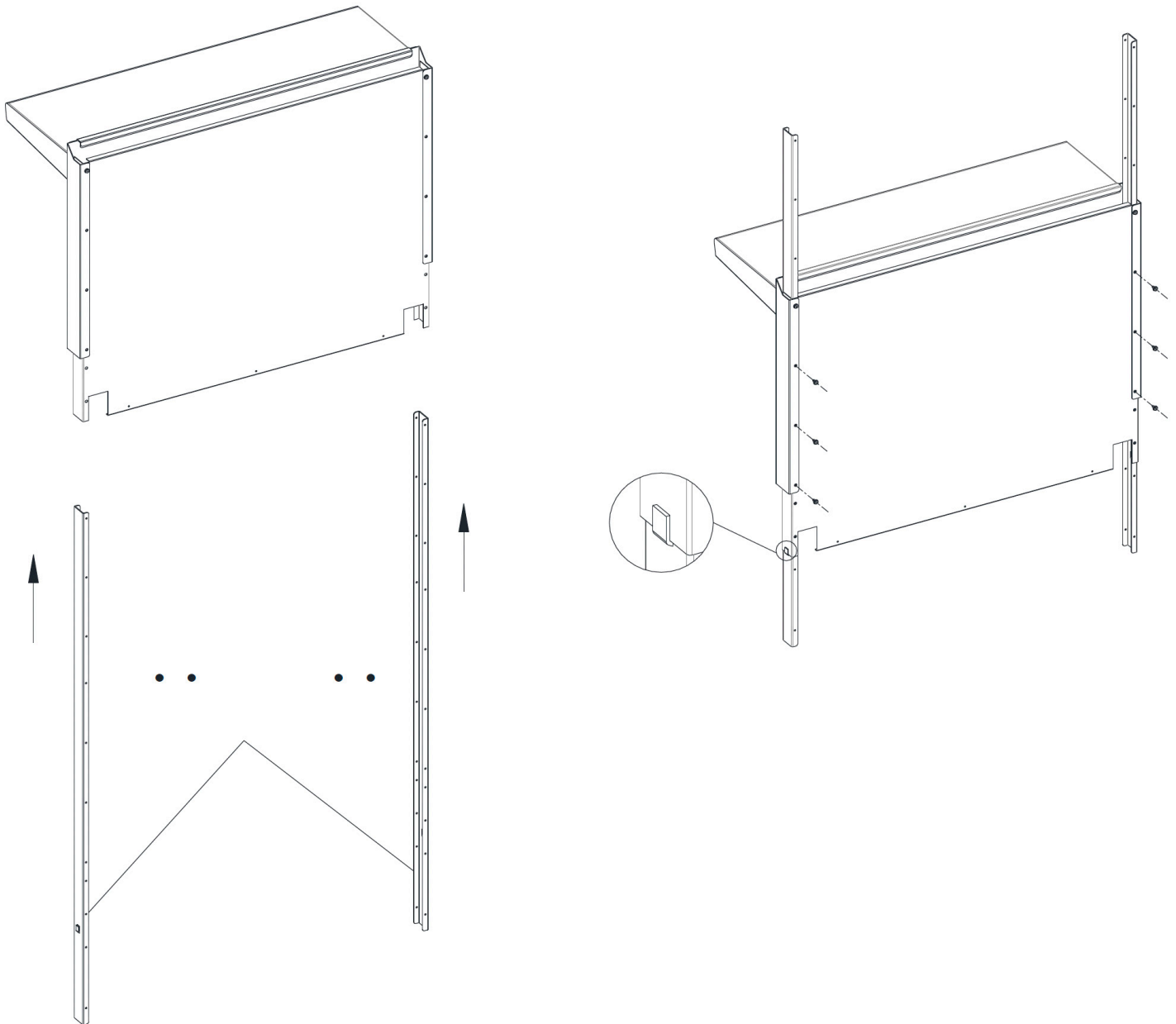

Step 3: Attach Rear Panel to Range

Install the connected rear panel onto the range. Fix it using tapping screws.

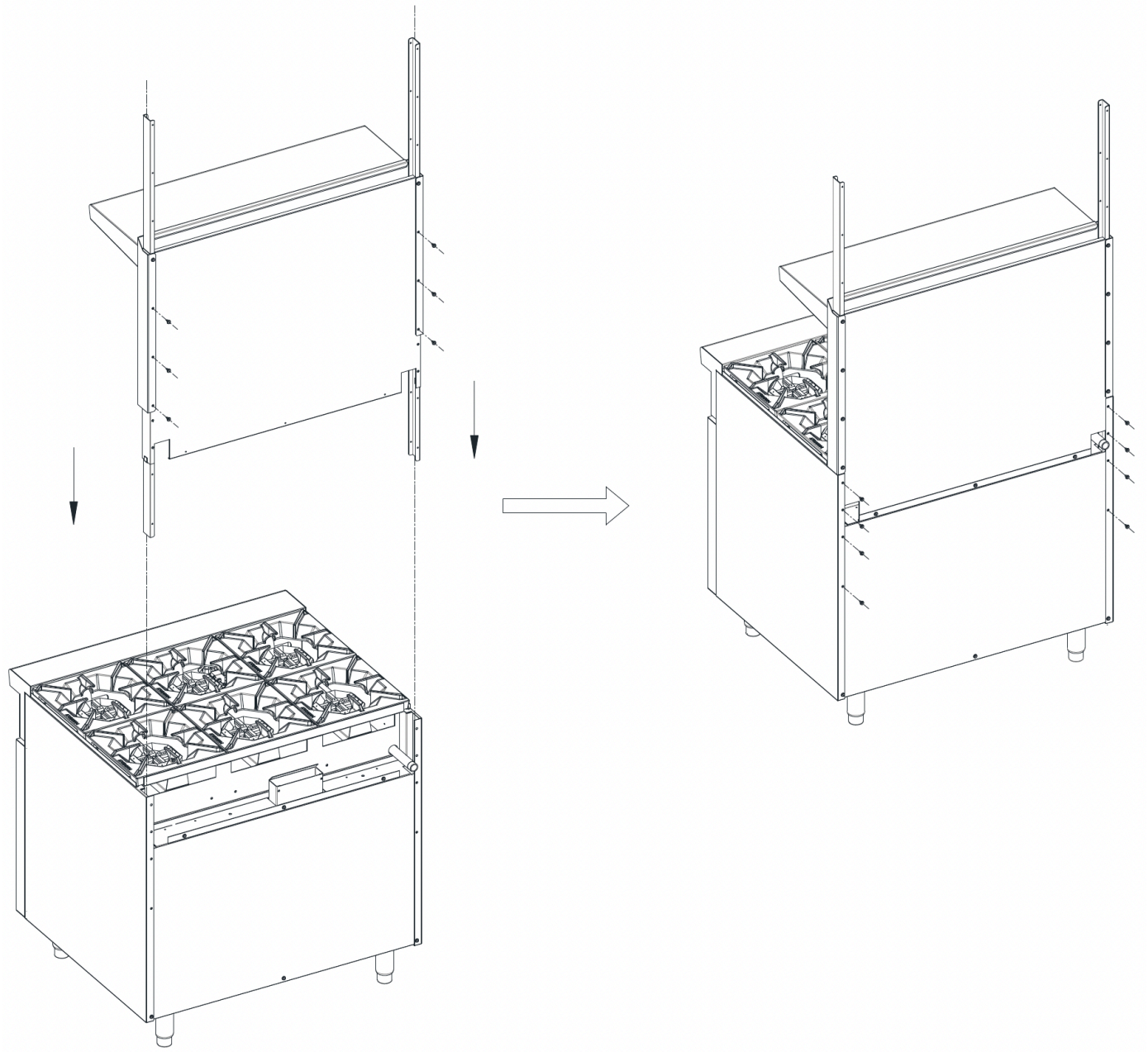

Step 4: Prepare the Salamander Broiler

Remove the tapping screws from the Salamander Broiler's rear panel.

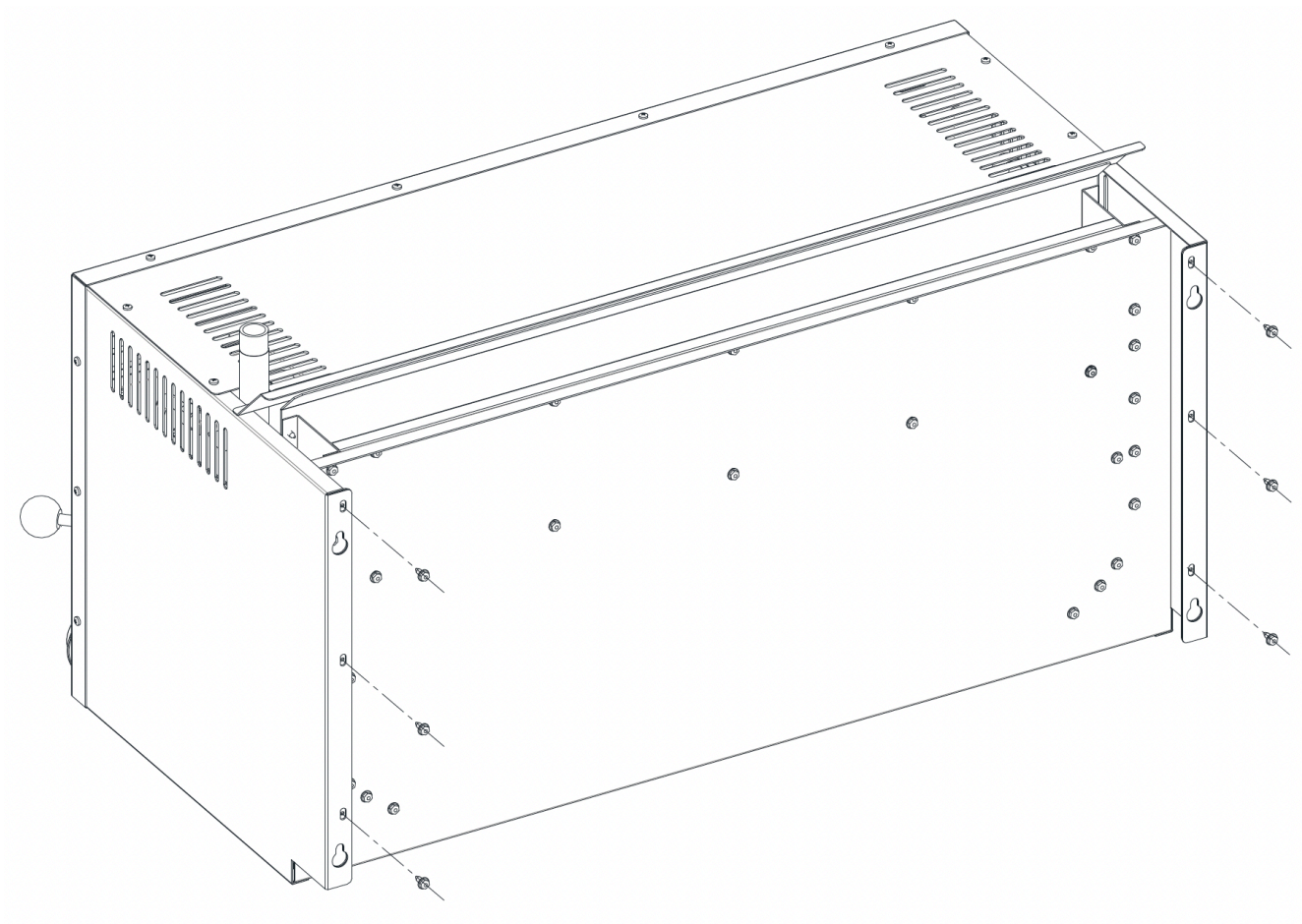

Step 5: Mount the Salamander Broiler to the Range

Using a lifting jack, insert the Salamander Broiler into the corresponding position on the range. Secure it using tapping screws.

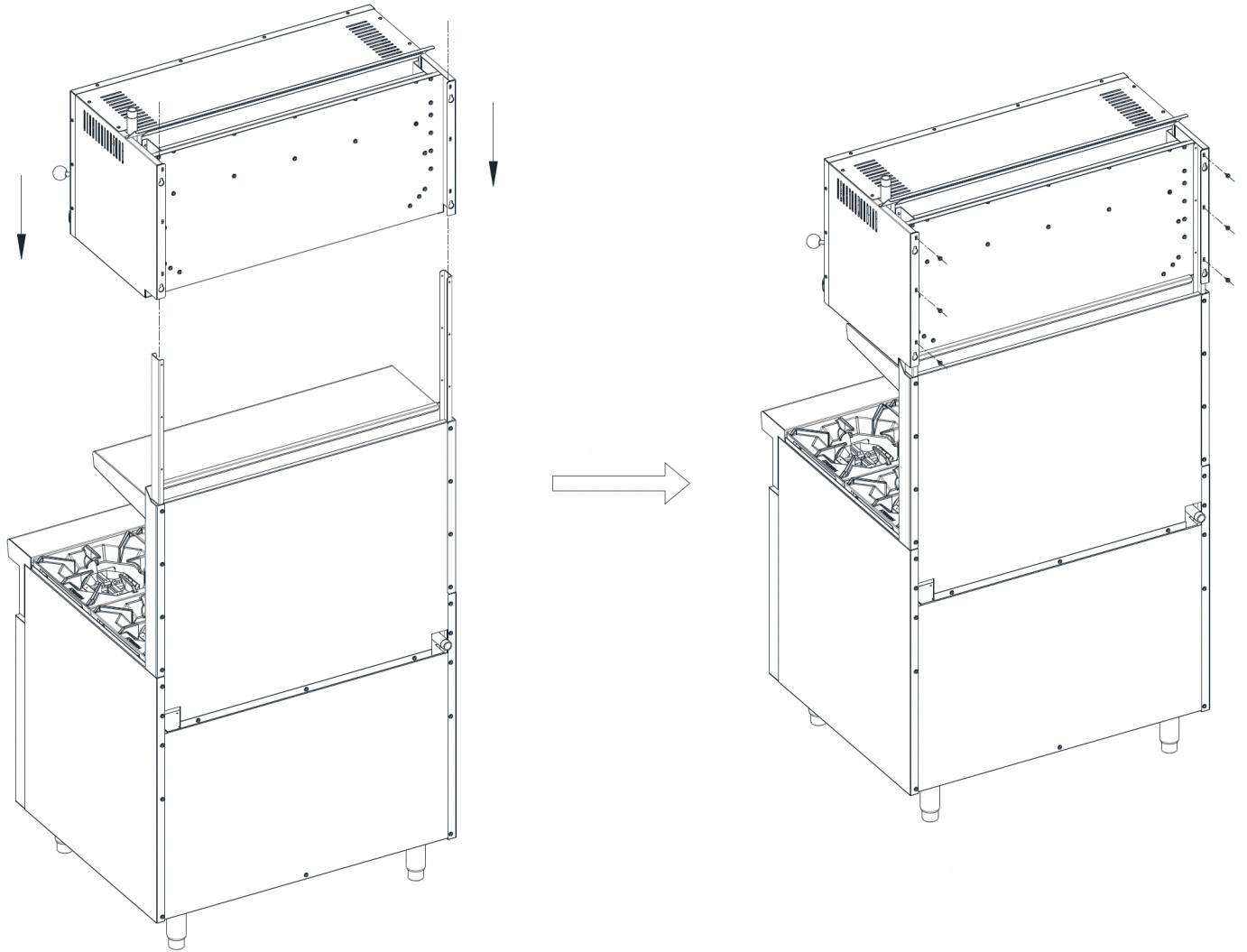

Additional Safety Notes:

- Ensure all connections are secure and the unit is stable before use.
- Follow all manufacturer guidelines and local building codes.
- Consult a professional installer if unsure about any step.



 Toll Free: (855) 855-0399

 info@atosausa.com

 www.atosausa.com